

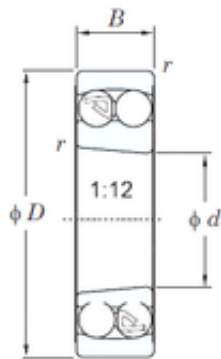

Ruville BEARING COMPANY

25 mm x 52 mm x 15 mm KOYO 1205K self aligning ball bearings



Bearing No. 1205K

1205K Bearing 2D drawings and 3D CAD models

Size	25x52x15 mm
Bore Diameter	25 mm
Outer Diameter	52 mm
Width	15 mm
d	25 mm
D	52 mm
B	15 mm
C	15 mm
r min.	1 mm
da min.	30 mm
Da max.	47 mm
ra max.	1 mm
Weight	0.138 Kg
Basic dynamic load rating (C)	12.1 kN
Basic static load rating (C0)	3.30 kN
(Grease) Lubrication Speed	12000 r/min
(Oil) Lubrication Speed	14000 r/min
Calculation factor (e)	0.28
Calculation factor (Y0)	2.39
Calculation factor (Y1)	2.28
Category	Self Aligning Ball Bearings
Inventory	0.0
Manufacturer Name	KOYO
Minimum Buy Quantity	N/A
Weight / Kilogram	0.149



Ruville BEARING COMPANY

EAN	0605790000935
Product Group	B00152
Mounting Method	Tapered Adapter
Enclosure	Open
Rolling Element	Ball Bearing
Adapter Sleeve	H-205X
Cage Material	Steel
Precision Class	ABEC 1 ISO P0
Internal Clearance	C0-Medium
Number of Rows of Balls	Double Row
Other Features	Allowable Misalignment 2.5 Deg 1:12 Taper
Long Description	25MM Bore; Tapered Adapter Mount; 52MM Outside Diameter; 15MM Inner Race Width; 15MM Outer Race Width; Open; Steel Cage; Double Row of Balls; ABEC 1 ISO P0; C0-Medium
Inch - Metric	Metric
Category	Self Aligning Ball Bearings
UNSPSC	31171532
Harmonized Tariff Code	8482.10.50.68
Noun	Bearing
Keyword String	Self Aligning
Manufacturer URL	http://www.koyousa.com
Manufacturer Item Number	1205K
Weight / LBS	0.30424
Outside Diameter	2.047 Inch 52 Millimeter
Bore	0.984 Inch 25 Millimeter
Inner Race Width	0.591 Inch 15 Millimeter
Outer Race Width	0.591 Inch 15 Millimeter