

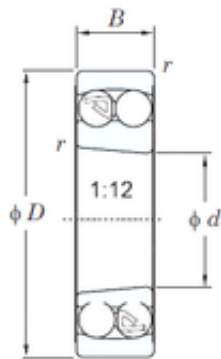

Ruville BEARING COMPANY

90 mm x 160 mm x 30 mm KOYO 1218K self aligning ball bearings



Bearing No. 1218K

1218K Bearing 2D drawings and 3D CAD models

Size	90x160x30 mm
Bore Diameter	90 mm
Outer Diameter	160 mm
Width	30 mm
d	90 mm
D	160 mm
B	30 mm
C	30 mm
r min.	2 mm
da min.	99 mm
Da max.	151 mm
ra max.	2 mm
Weight	2.48 Kg
Basic dynamic load rating (C)	56.8 kN
Basic static load rating (C0)	23.4 kN
(Grease) Lubrication Speed	3500 r/min
(Oil) Lubrication Speed	4300 r/min
Calculation factor (e)	0.17
Calculation factor (Y0)	3.86
Calculation factor (Y1)	3.69
Category	Self Aligning Ball Bearings
Inventory	0.0
Manufacturer Name	KOYO
Minimum Buy Quantity	N/A
Weight / Kilogram	2.681



Ruville BEARING COMPANY

Product Group	B00152
Mounting Method	Tapered Adapter
Enclosure	Open
Rolling Element	Ball Bearing
Adapter Sleeve	H-218X
Cage Material	Steel
Precision Class	ABEC 1 ISO P0
Internal Clearance	C0-Medium
Number of Rows of Balls	Double Row
Other Features	Allowable Misalignment 2.5 Deg 1:12 Taper
Long Description	90MM Bore; Tapered Adapter Mount; 160MM Outside Diameter; 30MM Inner Race Width; 30MM Outer Race Width; Open; Steel Cage; Double Row of Balls; ABEC 1 ISO P0; C0-Medium
Inch - Metric	Metric
Category	Self Aligning Ball Bearings
UNSPSC	31171532
Harmonized Tariff Code	8482.10.50.68
Noun	Bearing
Keyword String	Self Aligning
Manufacturer URL	http://www.koyousa.com
Manufacturer Item Number	1218K
Weight / LBS	5.46746
Inner Race Width	1.181 Inch 30 Millimeter
Outside Diameter	6.299 Inch 160 Millimeter
Bore	3.543 Inch 90 Millimeter
Outer Race Width	1.181 Inch 30 Millimeter