

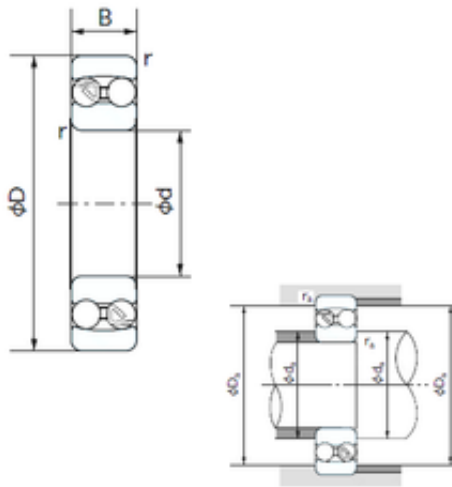

# Ruville BEARING COMPANY



65 mm x 140 mm x 33 mm NACHI 1313 self aligning ball bearings

Bearing No. 1313

1313 Bearing 2D drawings and 3D CAD models

Size	65x140x33 mm
Bore Diameter	65 mm
Outer Diameter	140 mm
Width	33 mm
d	65 mm
D	140 mm
B	33 mm
C	33 mm
r1 min.	2.1 mm
da min.	77 mm
Da max.	128 mm
ra max.	2 mm
Weight	2.45 Kg
Basic dynamic load rating (C)	62 kN
Basic static load rating (C0)	22,8 kN
(Grease) Lubrication Speed	4300 r/min
(Oil) Lubrication Speed	5300 r/min
Calculation factor (e)	0.23
Calculation factor (Y0)	2.9
Calculation factor (Y1)	2.8
Category	Self Aligning Ball Bearings
Inventory	0.0
Manufacturer Name	NACHI
Minimum Buy Quantity	N/A
Weight / Kilogram	0



## Ruville BEARING COMPANY

Product Group	B00152
Mounting Method	Shaft
Enclosure	Open
Rolling Element	Ball Bearing
Cage Material	Steel
Precision Class	ABEC 1   ISO P0
Internal Clearance	C0-Medium
Number of Rows of Balls	Double Row
Other Features	Allowable Misalignment 3 Deg
Long Description	65MM Bore; Shaft Mount; 140MM Outside Diameter; 33MM Inner Race Width; 33MM Outer Race Width; Open; Steel Cage; Double Row of Balls; ABEC 1   ISO P0; C0-Medium
Inch - Metric	Metric
Category	Self Aligning Ball Bearings
UNSPSC	31171532
Harmonized Tariff Code	8482.10.50.68
Noun	Bearing
Keyword String	Self Aligning
Manufacturer URL	<a href="http://www.nachi.com">http://www.nachi.com</a>
Weight / LBS	5.40132
Outside Diameter	5.512 Inch   140 Millimeter
Inner Race Width	1.299 Inch   33 Millimeter
Outer Race Width	1.299 Inch   33 Millimeter
Bore	2.559 Inch   65 Millimeter