

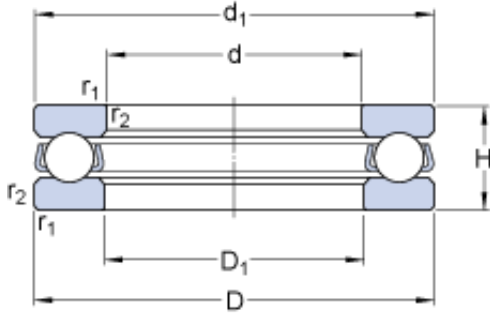

Ruville BEARING COMPANY



SKF 51236 M thrust ball bearings

Bearing No. 51236 M

51236 M Bearing 2D drawings and 3D CAD models

Size	250x180x56 mm
Bore Diameter	250 mm
Outer Diameter	180 mm
Width	56 mm
d	180 mm
D	250 mm
H	56 mm
d ₁	245 mm
D ₁	183 mm
r _{1,2} - min.	1.5 mm
d _a - min.	222 mm
D _a - max.	208 mm
r _a - max.	1.5 mm
Basic dynamic load rating - C	302 kN
Basic static load rating - C ₀	1120 kN
Fatigue load limit - P _u	28.5 kN
Reference speed	1200 r/min
Limiting speed	1600 r/min
Minimum load factor - A	6.1
Category	Thrust Ball Bearing
Inventory	0.0
Manufacturer Name	SKF
Minimum Buy Quantity	N/A
Weight / Kilogram	8.678
EAN	7316577121134



Ruville BEARING COMPANY

Product Group	B00308
Rolling Element	Ball Bearing
Thrust Bearing	Yes
Single or Double Direction	Single Direction
Banded	No
Cage Material	Brass
Precision Class	ABEC 1 ISO P0
Component Description	Roller Assembly Plus Raceways
Other Features	Single Row Roller Guided
Long Description	180MM Bore 1; 183MM Bore 2; 250MM Outside Diameter; 56MM Height; Ball Bearing; Single Direction; Not Banded; Brass Cage; ABEC 1 ISO P0 Precision
Inch - Metric	Metric
Category	Thrust Ball Bearings
UNSPSC	31171507
Harmonized Tariff Code	8482.10.50.08
Noun	Bearing
Keyword String	Ball Thrust
Manufacturer URL	http://www.skf.com
Manufacturer Item Number	51236 M
Weight / LBS	19.114
Height	2.205 Inch 56 Millimeter
Overall Height with Aligning Washer	0 Inch 0 Millimeter
Bore 1	7.087 Inch 180 Millimeter
Bore 2	7.205 Inch 183 Millimeter
Outside Diameter	9.843 Inch 250 Millimeter
d ₁	245 mm
D ₁	183 mm
r _{1,2} min.	1.5 mm



Ruville BEARING COMPANY

d_a min.	222 mm
D_a max.	208 mm
r_a max.	1.5 mm
Basic dynamic load rating C	296 kN
Basic static load rating C_0	1080 kN
Fatigue load limit P_u	27 kN
Minimum load factor A	6.1
Mass bearing (including seat washer where applicable)	8.6 kg